



COMET

Small footprint, a lot of comfort

YALA's popular Comet design is a classic glamping tent that easily fits onto small camping ground pitches. The Comet is now available in three sizes (NEW!) and can, therefore, suit groups of 2-5 guests. Each size is compact, but with an efficient layout so that your guests still have all the space they need.

With a kitchen, dining area, one or two bedrooms, an optional bathroom, and a large veranda, you can offer your guests fantastic accommodation facilities. It's the ideal place to come back to and relax after a day filled with adventure. The vertical windows at the front and side of the Comet let light flood into the kitchen and living area and guests will be able to make the most of their surroundings. A mesh window is situated at the front to guarantee optimal ventilation.

We use the best materials available, including fire retardant canvas. The roof comes in a range of colours – brown, beige, green and, unique for the Comet, grey – so that you can choose the look that best suits your site. The Comet can be built on concrete tiles instead of a foundation with wooden poles, therefore not requiring any earthwork.

- ✔ Small footprint to fit into smaller camping ground pitches
- ✔ Now available with a new grey roof colour and with large windows to let your guests enjoy the view
- ✔ Fire retardant canvas for safety and insurance purposes
- ✔ Option to build on concrete tiles – so no earthwork is required



SPECIFICATIONS COMET 16

Dimensions

Inner tent	16.0 m ²	4.0 x 4.0 m
Veranda	8.4 m ²	4.0 x 2.1 m
Total surface	24.4 m ²	4.0 x 6.1 m
Footprint	53.1 m ²	5.9 x 9.0 m

Features

# Guests	4
# Bedrooms	22
Bathroom	No
Kitchen	Yes

Floorplan 2D



SPECIFICATIONS COMET 20

Dimensions

Inner tent	20.3 m ²	4.5 x 4.5 m
Veranda	9.5 m ²	4.5 x 2.1 m
Total surface	29.8 m ²	4.5 x 6.6 m
Footprint	57.6 m ²	6.4 x 9.0 m

Features

# Guests	2 - 5
# Bedrooms	1 - 2
Bathroom	Optional
Kitchen	Yes

Floorplan 3D

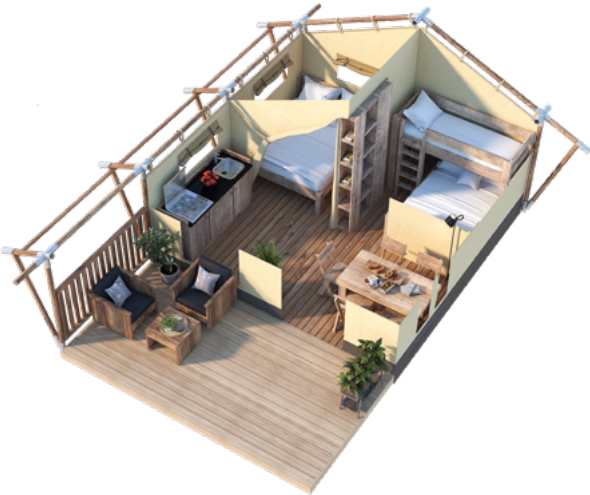

Floorplan 2D



SPECIFICATIONS COMET 27

Dimensions

Inner tent	27.0 m ²	4.5 x 6.0 m
Veranda	9.5 m ²	4.5 x 2.1 m
Total surface	36.5 m ²	4.5 x 8.1 m
Footprint	67.2 m ²	6.4 x 10.5 m

Features

# Guests	5
# Bedrooms	2
Bathroom	Yes
Kitchen	Yes

Floorplan 3D



Floorplan 2D



PHOTOS COMET



SPECIFICATIONS COMET

Elements	Colour	Specifications	Technical standards
PVC Roof	Beige Brown Green	UV and flame retardant PVC 650gr/m ² . The PVC is easy to clean and meets the stringent European, British and American fire regulations (M2, B2 and DIN 4102 standard).	BS 7837 DIN 4102 – Class B2 M2 Classification NFP 92-503 EN 13501-1 B-s3, d0 Total weight DIN and ISO 2286-2 – 650 gr/m ²
Flame retardant Polyester (FPTC420)	Khaki	Flame retardant 420 gr/m ² . The fibers in this fabric provide extra security and protection. It is scorch, glow and spark resistant. Textile material that is flame retardant has an inhibiting effect on the occurrence of fire and slow fire spreading.	Weight 420gr/m ² + 5% Standarder width: 150 cm Tearing strenght: ±10% - Warp: 76N - Weft: 53N Tensile strength: ± 10% - Warp: 2800N/5 cm - Weft: 2232N/5 cm Watercolumn: ≥ 400mm Color fading level: GR6 ISO105B04-1994 Mildewtreated: Level 0 AATCC30-2017 Fireproof level: M2 BS7837-1996
Fixing		The inner tent hanging system is a unique system. It has no point loading, so the weight is equally distributed across the surface of the structure.	
Construction		The connectors of the construction are made from 3 mm hot dipped galvanized steel. The poles have a diameter of 80 or 100 mm.	

Why choose us?

It's all in the detail. Our beautiful, sustainable glamping tents are not mass produced, but are created by a team of specialists with a passion for outdoor living. We personally manage every aspect, from the initial concept and product design, to the sourcing of eco-friendly materials and construction, to quality control. And it doesn't stop there, we provide ongoing service and support, long after you bought your tent or lodge.

Interested?

Get in touch to find out more about our tents, or come and see them for yourself. Email us on sales@yalacanvaslodges.com and we'll get right back to you or call us on +31 (0) 527 620 325.

